

# Line Markers and Signage for Hazardous Liquid Pipelines and Facilities

API RECOMMENDED PRACTICE 1109  
FIFTH EDITION, OCTOBER 2017

This copy is provided courtesy of the American Petroleum Institute in support of Call Before You Dig 811 Day.

© 2018 American Petroleum Institute. All rights reserved. You may not edit, reproduce, or distribute this document by electronic or other means, including via e-mail. If you receive a copy of this document in violation of these terms of use, please report to API at [APIpubs@api.org](mailto:APIpubs@api.org).



AMERICAN PETROLEUM INSTITUTE

# API Compass®

One Platform. All of Your Content.

API COMPASS

SIGN IN

HOME CONTACT REGISTER LANGUAGES

Welcome API Members and Customers

energy API

All Search keyword(s), designation, author

API Compass delivers new tools to find and engage standards quickly and accurately.

Access the entire API standards collection or select from specific sections, depending on your industry. Get the current standards, all supplemental documents, as well as historical versions right here.

Exploration and Production  
Petroleum Measurement  
Marketing  
Transportation  
Refining  
Safety and Fire Protection  
Health and Environmental Issues

MY TOOLS

My Annotations  
My Bookmarks  
My Groups  
Standards Shared with Me  
Subscription Details

Powered By:  
ASTM COMPASS®

Get 24/7 access to all the API standards your organization needs with an API Compass subscription. Choose the complete API collection of standards or customize a segment-specific collection of API content. Stay ahead of change with the most up-to-date documents right at your fingertips.

Save time and money with organization-wide access plus powerful workflow tools to:

- See the changes between editions of API standards via color-coded highlights
- Add shareable notes to document your institutional knowledge
- Bookmark popular standards within your organization
- Receive automatic notifications of revisions and newer editions of standards
- And much more

**Order your customized API Compass subscription today.**

**[www.api.org/compass](http://www.api.org/compass) • +1.866.284.0169**



AMERICAN PETROLEUM INSTITUTE

© 2018 American Petroleum Institute. All rights reserved.

You may not edit, reproduce, or distribute this document by electronic or other means, including via e-mail. If you receive a copy of this document in violation of these terms of use, please report to API at [APIpubs@api.org](mailto:APIpubs@api.org).

## Special Notes

API publications necessarily address problems of a general nature. With respect to particular circumstances, local, state, and federal laws and regulations should be reviewed.

Neither API nor any of API's employees, subcontractors, consultants, committees, or other assignees make any warranty or representation, either express or implied, with respect to the accuracy, completeness, or usefulness of the information contained herein, or assume any liability or responsibility for any use, or the results of such use, of any information or process disclosed in this publication. Neither API nor any of API's employees, subcontractors, consultants, or other assignees represent that use of this publication would not infringe upon privately owned rights.

API publications may be used by anyone desiring to do so. Every effort has been made by the Institute to ensure the accuracy and reliability of the data contained in them; however, the Institute makes no representation, warranty, or guarantee in connection with this publication and hereby expressly disclaims any liability or responsibility for loss or damage resulting from its use or for the violation of any authorities having jurisdiction with which this publication may conflict.

API publications are published to facilitate the broad availability of proven, sound engineering and operating practices. These publications are not intended to obviate the need for applying sound engineering judgment regarding when and where these publications should be utilized. The formulation and publication of API publications is not intended in any way to inhibit anyone from using any other practices.

Any manufacturer marking equipment or materials in conformance with the marking requirements of an API standard is solely responsible for complying with all the applicable requirements of that standard. API does not represent, warrant, or guarantee that such products do in fact conform to the applicable API standard.

Information concerning safety and health risks and proper precautions with respect to particular materials and conditions should be obtained from the employer, the manufacturer or supplier of that material, or the material safety data sheet.

Where applicable, authorities having jurisdiction should be consulted.

Work sites and equipment operations may differ. Users are solely responsible for assessing their specific equipment and premises in determining the appropriateness of applying the RP. At all times users should employ sound business, scientific, engineering, and judgment safety when using this RP.

API is not undertaking to meet the duties of employers, manufacturers, or suppliers to warn and properly train and equip their employees, and others exposed, concerning health and safety risks and precautions, nor undertaking their obligations to comply with authorities having jurisdiction.

All rights reserved. No part of this work may be reproduced, translated, stored in a retrieval system, or transmitted by any means, electronic, mechanical, photocopying, recording, or otherwise, without prior written permission from the publisher. Contact the Publisher, API Publishing Services, 1220 L Street, NW, Washington, DC 20005.

*Copyright © 2017 American Petroleum Institute*

© 2018 American Petroleum Institute. All rights reserved.

You may not edit, reproduce, or distribute this document by electronic or other means, including via e-mail. If you receive a copy of this document in violation of these terms of use, please report to API at [APIpubs@api.org](mailto:APIpubs@api.org).

## Foreword

Nothing contained in any API publication is to be construed as granting any right, by implication or otherwise, for the manufacture, sale, or use of any method, apparatus, or product covered by letters patent. Neither should anything contained in the publication be construed as insuring anyone against liability for infringement of letters patent.

The verbal forms used to express the provisions in this document are as follows.

Shall: As used in a standard, “shall” denotes a minimum requirement in order to conform to the standard.

Should: As used in a standard, “should” denotes a recommendation or that which is advised but not required in order to conform to the standard.

May: As used in a standard, “may” denotes a course of action permissible within the limits of a standard.

Can: As used in a standard, “can” denotes a statement of possibility or capability.

This document was produced under API standardization procedures that ensure appropriate notification and participation in the developmental process and is designated as an API standard. Questions concerning the interpretation of the content of this publication or comments and questions concerning the procedures under which this publication was developed should be directed in writing to the Director of Standards, American Petroleum Institute, 1220 L Street, NW, Washington, DC 20005. Requests for permission to reproduce or translate all or any part of the material published herein should also be addressed to the director.

Generally, API standards are reviewed and revised, reaffirmed, or withdrawn at least every five years. A one-time extension of up to two years may be added to this review cycle. Status of the publication can be ascertained from the API Standards Department, telephone (202) 682-8000. A catalog of API publications and materials is published annually by API, 1220 L Street, NW, Washington, DC 20005.

Suggested revisions are invited and should be submitted to the Standards Department, API, 1220 L Street, NW, Washington, DC 20005, [standards@api.org](mailto:standards@api.org).

© 2018 American Petroleum Institute. All rights reserved.

You may not edit, reproduce, or distribute this document by electronic or other means, including via e-mail.  
If you receive a copy of this document in violation of these terms of use, please report to API at [APIpubs@api.org](mailto:APIpubs@api.org).

## Contents

	Page
<b>1</b>	<b>Scope</b> ..... <b>1</b>
<b>2</b>	<b>Normative References</b> ..... <b>1</b>
<b>3</b>	<b>Terms and Definitions</b> ..... <b>1</b>
<b>4</b>	<b>Conflicting Requirements</b> ..... <b>3</b>
<b>5</b>	<b>Pipeline Facility Marking Practice</b> ..... <b>3</b>
<b>5.1</b>	<b>General Description, Use, and Placement of Signage</b> ..... <b>3</b>
<b>5.2</b>	<b>Types of Posts</b> ..... <b>4</b>
<b>5.3</b>	<b>Line Markers</b> ..... <b>4</b>
<b>5.4</b>	<b>Signage</b> ..... <b>6</b>
<b>5.5</b>	<b>Installation</b> ..... <b>8</b>
<b>6</b>	<b>Aboveground Pipeline Facility Marking and Signage Practice</b> ..... <b>10</b>
<b>6.1</b>	<b>Pipelines</b> ..... <b>10</b>
<b>6.2</b>	<b>Pipeline Facilities Signs</b> ..... <b>10</b>
<b>6.3</b>	<b>Sign Placement</b> ..... <b>10</b>
<b>7</b>	<b>Inspections and Maintenance</b> ..... <b>10</b>

## Figures

<b>1</b>	<b>Examples of Cross Country Right-of-Way Marking Locations</b> ..... <b>5</b>
<b>2</b>	<b>Examples of Cross Country Markers and Signs</b> ..... <b>6</b>
<b>3</b>	<b>Examples of Offset Markers and Signs</b> ..... <b>7</b>
<b>4</b>	<b>Line Markers</b> ..... <b>9</b>
<b>5</b>	<b>Line Marker</b> ..... <b>11</b>
<b>6</b>	<b>Examples of Surface Markers</b> ..... <b>12</b>
<b>7</b>	<b>Pipeline Sign for Navigable Waterways</b> ..... <b>13</b>
<b>8</b>	<b>Typical Aerial Markers</b> ..... <b>14</b>
<b>9</b>	<b>Typical Pipeline Facility Signs</b> ..... <b>15</b>

## Introduction

Pipelines are, for the most part, buried conduits. As such, they operate safely, quietly, and hidden from view, with little disruption to the public or the surrounding environment. These attributes, which are highly desirable in any mode of transportation, generate the need for an organized system of markers and signs that visually alert the public to the presence of a pipeline and provide a contact number of the Pipeline Operator that can be used in the event of an emergency or before excavating near pipelines. Strategic placement of markers and signs also helps the Pipeline Operator to perform right-of-way surveillance, inspections and other day-to-day activities. Pipeline markers are an integral component of an Operator's operating and maintenance program including damage prevention and public awareness programs.

This recommended practice (RP) was prepared by a committee composed of representatives from pipeline operating companies. Its purpose is to present guidelines concerning the design, fabrication, installation, and maintenance of permanently installed pipeline markers and signs.

© 2018 American Petroleum Institute. All rights reserved.

You may not edit, reproduce, or distribute this document by electronic or other means, including via e-mail.  
If you receive a copy of this document in violation of these terms of use, please report to API at [APIpubs@api.org](mailto:APIpubs@api.org).



# Marking Liquid Petroleum Pipeline Facilities

## 1 Scope

**1.1** This RP addresses the permanent marking of hazardous liquid pipeline transportation facilities. It covers the design, message, installation, placement, inspection, and maintenance of markers and signs on pipeline facilities located onshore and at inland waterway crossings. Markers and signs indicate the presence of a pipeline facility and warn of the potential hazards associated with its presence and operation. The markers and signs may contain information to be used by the public when reporting emergencies and seeking assistance in determining the location of a buried pipeline.

**1.2** The provisions of this RP cover the minimum signage (markers and signs) requirements for hazardous liquid pipeline facilities. The Pipeline Operator is responsible for determining the type and extent of signage. Consideration should be given to the hazardous characteristics of the commodity being transported; the pipeline's proximity to industrial, commercial, residential, and environmentally sensitive areas; susceptibility to excavation-related damage; consequences of failure; and applicable state and federal laws. Several examples of markers and signs with locations are illustrated in Figure 1, Figure 2, Figure 3, Figure 4, Figure 6, and Figure 8. The pipeline marking programs are integral components of the Pipeline Operator's operations, maintenance and emergency plans, damage prevention programs, and public awareness programs.

## 2 Normative References

The following referenced documents are indispensable for the application of this document. For dated references, only the edition cited applies. For undated references, the latest edition of the referenced document (including any amendments) applies.

ASME B31.4 <sup>1</sup>, Pipeline Transportation Systems for Liquids and Slurries

49 Code of Federal Regulations Part 195 <sup>2</sup>, "Transportation of Hazardous Liquids by Pipeline"

## 3 Terms and Definitions

For the purposes of this document, the following definitions apply.

### 3.1

#### **aerial patrol or air patrol marker**

A marker observable from the air, which is used to identify a pipeline's reference location by the aerial patrol pilot while conducting aerial surveillance of a pipeline right-of-way (ROW).

**NOTE** Information on the marker might consist of distance from a point of reference, usually in miles, name or numbers of above ground facilities, direction of the ROW, a Point of Intersection (PI) where the ROW turns, or other information useful to the pilot.

### 3.2

#### **hazardous liquid**

Petroleum, petroleum products, anhydrous ammonia, ethanol, or carbon dioxide and any substance that may pose an unreasonable risk to life or property if released, when transported by a hazardous liquid pipeline facility in a liquid state.

---

<sup>1</sup> ASME International, 3 Park Avenue, New York, NY 10016-5990, [www.asme.org](http://www.asme.org).

<sup>2</sup> The *Code of Federal Regulations* is available from the U.S. Government Printing Office, Washington, DC 20402.

**3.3****line marker or pipeline marker**

Signage used along the pipeline ROW and at above ground pipeline facilities to alert the public and emergency responders of the presence of a pipeline facility.

**3.4****petroleum**

Crude oil, condensate, natural gasoline, natural gas liquids, and liquefied petroleum gas.

**3.5****petroleum product**

Flammable, toxic, or corrosive products obtained from distilling and processing of crude oil, unfinished oils, natural gas liquids, blend stocks, and other miscellaneous hydrocarbon compounds.

**3.6****other markers**

Signage other than aerial patrol, air patrol marker, line marker, or pipeline marker used to identify the presence of a pipeline facility solely for the benefit of a Pipeline Operator or to provide additional information concerning the location or facility.

**3.7****pipeline facility**

New and existing pipe; rights-of-way; and any equipment, facility, or building used in the transportation of hazardous liquids or carbon dioxide.

**3.8****pipeline operator**

Any individual, firm, joint venture, partnership, corporation, association, state, municipality, and cooperative association, including any trustee, receiver, assigned or personal representative thereof, who owns and operates a pipeline system.

**3.9****pipeline system**

All parts of a pipeline facility through which hazardous liquid is transported that includes, but is not limited to, pipe; valves, and other appurtenances connected to the pipe; pumping units, along with the fabricated assemblies associated with the pumping units; metering and delivery stations and fabricated assemblies therein; and breakout tanks.

**3.10****Point of Inflection****PIs**

A change in the pipeline(s) direction or point of intersection.

**3.11****sign**

A publicly displayed or posted notice, board, or other device bearing letters, symbols, and/or designs to convey a designation, name, direction, information, instruction, warning, or other message.

**3.12****signage**

Permanent signs, collectively, including aerial patrol or air patrol markers, line markers, pipeline markers, other markers, and signs, such as those around pump stations and breakout stations used to warn or notify the public or emergency responders regarding the presence of a pipeline facility and telephone number of the Operator.

NOTE Temporary signage, such as flags, stakes, and other markings used to temporarily mark facilities for the purpose of excavation-related work, is not addressed by this RP.

## 4 Conflicting Requirements

If any provisions of this RP present a direct or implied conflict with any statutory regulation, the regulation shall govern. However, if this RP's recommendations are more stringent than the requirements of the regulation, then the recommendations presented herein should be considered.

## 5 Pipeline Facility Marking Practice

### 5.1 General Description, Use, and Placement of Signage

5.1.1 Signage can be found in various shapes, sizes, and designs. Permanent pipeline facility markers and signs are used to convey the following information to the public and emergency responders:

- a) the presence of a hazardous liquid pipeline facility;
- b) the word "Warning," "Caution," or "Danger" followed by the words "Petroleum (or the name of the hazardous liquid transported) Pipeline" or "Carbon Dioxide Pipeline";
- c) name of Operator and a telephone number (including area code) where the Operator can be reached 24 hours a day to:
  - 1) determine the location of the buried pipeline,
  - 2) receive authorization to cross or occupy the pipeline rights-of-way,
  - 3) report emergencies relating to the pipeline or pipeline right-of-way.

NOTE Before installing line markers, notify local One Call Center in accordance with state One Call laws and regulations.

5.1.2 Pipeline personnel may use pipeline markers, aerial markers and other signs to readily identify pipelines, pipeline right-of-way, or crossings for day-to-day operation and maintenance activities or emergency response.

5.1.3 Regulations require pipeline markers to be located at each public road crossing, at each railroad crossing, and in sufficient number along the remainder of each buried line so that its location is accurately known. Markers should be located along bends or inflection points along the pipeline so that the route of the buried pipeline's location is accurately known. Consideration should also be given to installing signage at each river crossing if permissible.

When installing aerial markers, consideration should be given to terrain, land use adjoining the ROW, flight paths, and physical points along the ROW to be identified, such as PIs and main line-lateral take-offs. When determining the frequency and spacing between markers, consideration should be given to land use, terrain, environment, population density, local ordinances, and other damage prevention considerations such as special excavation activity, One Call law exemptions, and frequency of excavated related near misses.

Line markers should be installed over each pipeline; there are locations where this is impractical, such as when a pipeline runs down the middle of the street, parallels the road under the shoulder, or traverses heavily developed urban areas. Supplemental signage such as curb markers, ground level markers or pavement decals should also be considered.

When determining the frequency and spacing between markers, consideration should be given to land use, terrain, environment, population density, and local ordinances. Damage prevention measures, such as extensive or unusual

excavation activity, areas exempted under One Call laws, and locations where excavation near misses have occurred, may also be examined when considering a location of a marker.

When line markers cannot be placed directly over or adjacent to the pipeline, it is recommended the signage clearly indicate that the pipeline is an offset line marker. Examples of offset markers are shown in Figure 3.

At a minimum, locations should be chosen to meet or exceed the requirements of 49 *CFR* Part 195. Examples of cross country right-of-way line markings are shown in Figure 1 and Figure 2.

## 5.2 Types of Posts

The type of post used will be dependent on the signage used and location. Posts may be made of any materials that will ensure adequate strength, stiffness, visibility, and durability. To maintain structural integrity and appearance, some post materials require surface protection against above- and below-ground corrosion or weathering. A proven coating system that provides a suitable finish and nonfading color should be selected for this purpose. When choosing the post material considerations should be given to the type of environment the post is exposed too. The following criteria should be applied in the selection of marker posts:

- a) metal pipe posts should be straight, sound, and have a nominal diameter of 2 in. or larger.
- b) metal structures designed for use as posts may be used.

When installing signage with steel posts, there should be a minimum of 12 in. of clearance between the steel post and the outside of the pipe (49 *CFR* Part 195.250). If 12 in. of clearance is impracticable, the clearance may be reduced if adequate provisions are made to protect the pipeline from electrical surges such as lightning strikes and for corrosion control.

- c) Straight posts made from debarked trees and treated with a pressure-applied chemical preservative may be used. The post should be sized to provide multiple years of use with consideration for burial type, burial depth, soil condition, etc. Wood posts are not recommended where brush or grass fires may be reasonably expected.
- d) Square precast reinforced-concrete posts having a minimum cross-sectional area of 16 in.<sup>2</sup> may be used. Special conditions, such as spalling during freeze and thaw cycles, should be considered when specifying material for these types of posts.
- e) Posts made of polyvinyl-chloride (PVC), polyethylene, and fiberglass may be used. Materials used should be resistant to ultraviolet exposure and suited to the environment where they are installed (see Figure 3).
- f) Other materials are acceptable provided they meet the general criteria discussed above.

## 5.3 Line Markers

**5.3.1** 49 *CFR* Part 195 requires that certain information be presented on line markers in lettering of a certain size and stroke. The regulations further require that line markers be placed over all buried pipelines at each public road crossing and at each railroad crossing in sufficient numbers along the remainder of each buried pipeline so that its location is accurately known.

**5.3.2** The line marker's message should be presented on strong, durable material finished to resist the effects of exposure and vandalism. The message should state at least the following: "WARNING," "Caution" or "Danger" followed by the words "PETROLEUM [or the name of the liquid petroleum transported] PIPELINE." The lettering should be at least 1 in. high with an approximate stroke of 1/4 in. on a background of sharply contrasting color. It should also contain the name of the Pipeline Operator with a telephone number, including an area code, where the Pipeline Operator can be reached at all times.

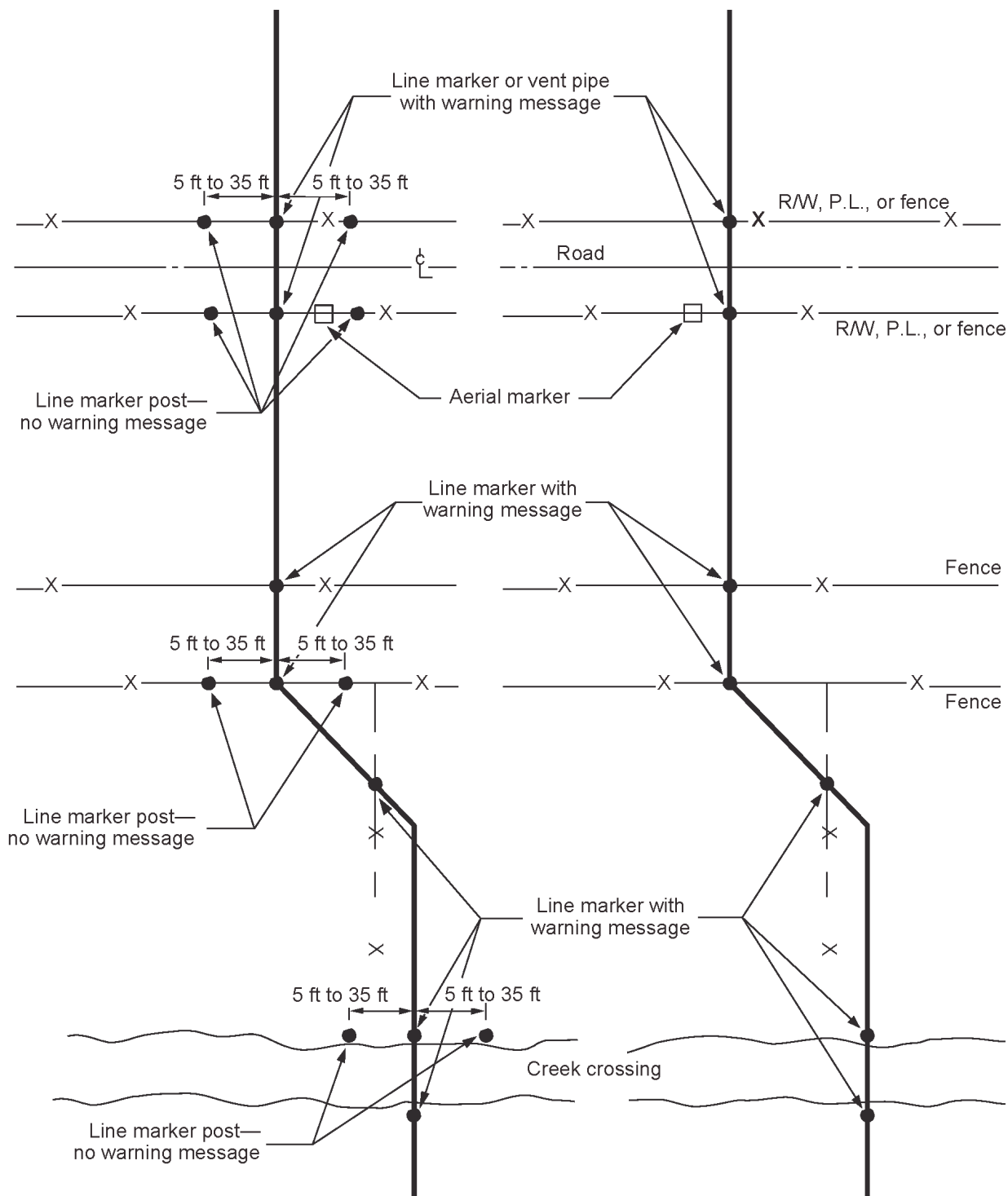

NOTE 1 R/W = right-of-way or ROW  
 NOTE 2 P.L. = property line

**Figure 1—Examples of Cross Country Right-of-Way Marking Locations**

© 2018 American Petroleum Institute. All rights reserved.

You may not edit, reproduce, or distribute this document by electronic or other means, including via e-mail. If you receive a copy of this document in violation of these terms of use, please report to API at APIpubs@api.org.

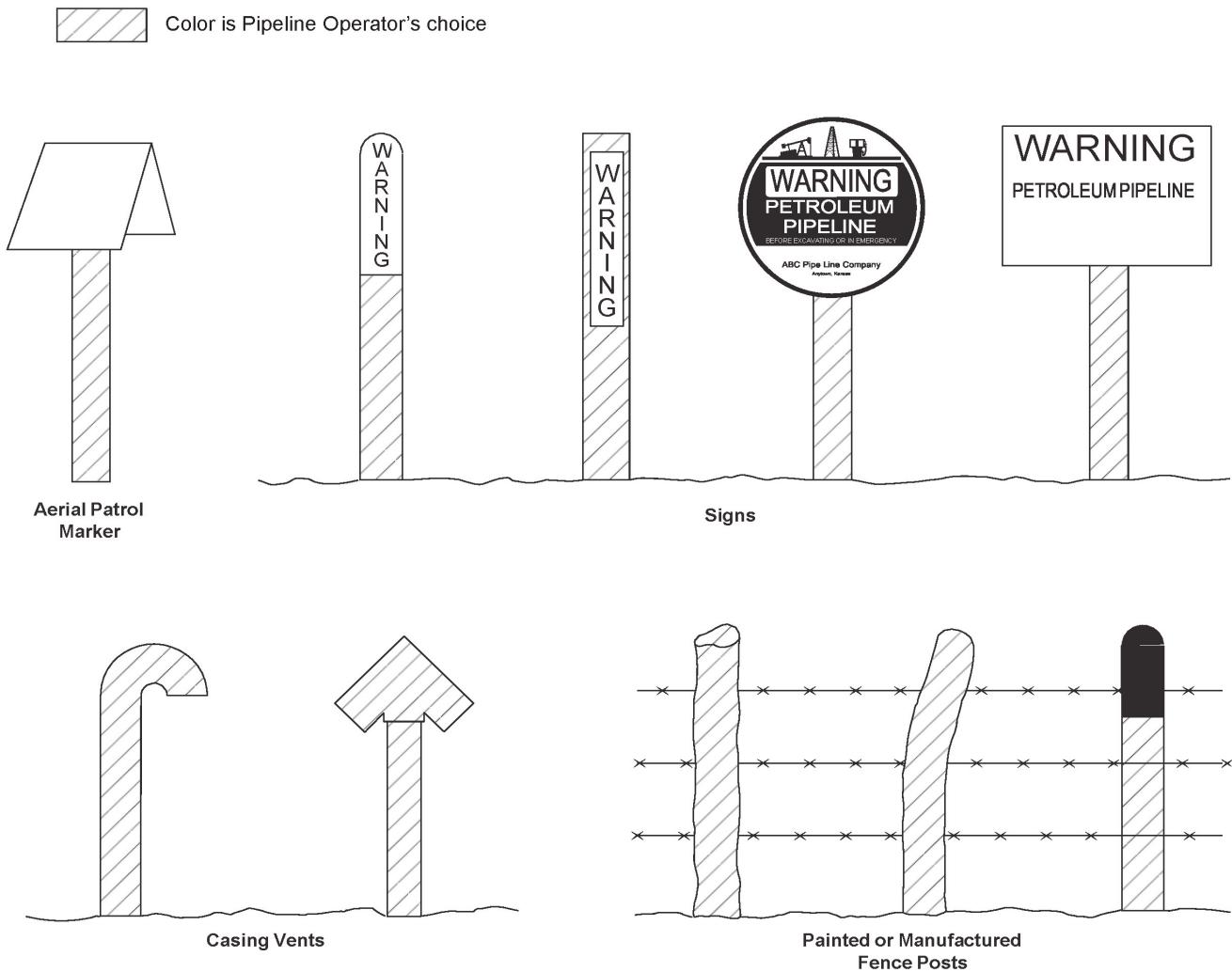

**Figure 2—Examples of Cross Country Markers and Signs**

**5.3.3** The line markers depicted in Figure 3 and Figure 4 are examples of line markers in general use by the liquid petroleum pipeline industry. The dimensions, wording, colors, and configuration shown on the figures are recommended for good visibility. The size and style of the lettering identifying the Pipeline Operator are optional. A trademark or other identifying symbol may appear as part of the Pipeline Operator's identification.

**5.3.4** Caution should be used when installing a line marker anywhere other than directly over or in proximity to the buried pipeline to avoid any possible misinterpretation as to where the actual pipeline is located. Examples of Offset Markers are shown in Figure 3.

## 5.4 Signage

**5.4.1** The Pipeline Operator may use markers and signs in addition to line markers to aid in determining the location of the pipeline. Examples of additional markers are included:

- a) aerial patrol markers;



Figure 3—Examples of Offset Markers and Signs

© 2018 American Petroleum Institute. All rights reserved.

You may not edit, reproduce, or distribute this document by electronic or other means, including via e-mail. If you receive a copy of this document in violation of these terms of use, please report to API at [APIpubs@api.org](mailto:APIpubs@api.org).

- b) prominently colored posts at fences, and right-of-way limits of roads and railroads;
- c) markers at banks of water crossings;
- d) stenciled markings on the surface of pavements (see Figure 5);
- e) buried tape or warning mesh;
- f) casing vents;
- g) cathodic protection test stations;
- h) any other kind of marker the Operator recognizes as necessary in such locations.

**5.4.2** When signs are used to identify pipeline crossings at navigable waterways they should contain the words "DO NOT ANCHOR OR DREDGE." The sign's lettering should not be less than 12 in. high, with an approximate stroke of 1 <sup>3</sup>/<sub>4</sub> in. on a background of sharply contrasting color. This lettering is in addition to the information recommended in 5.3.1 and 5.3.2. Because government agencies or authorities may share jurisdiction over certain navigable waterways, the specifications for and placement of markers for a particular waterway should satisfy those joint requirements. Many agencies accept or adopt the requirements of the United States Army Corps of Engineers. Figure 7 shows an appropriate navigable waterway sign.

**5.4.3** The Pipeline Operator may elect to place markers of special design in particular locations where current or projected activities may warrant their installation. Consideration should be given to whether the markers are for temporary or permanent service.

**5.4.4** Aerial patrol markers may be used along the routes of pipelines that are patrolled by aircraft. Figure 8 is an example of a typical aerial marker. When used, aerial markers should be placed or positioned at locations where they can easily be identified from the air.

## **5.5 Installation**

**5.5.1** Typically, the message portion of any marker is attached to, or is an integral part of, a post of the type described in 5.2.

**NOTE** Before installing line markers, notify the local One Call Center in accordance with State One Call laws and regulations.

**5.5.2** The following factors should be considered in determining the depth to bury marker posts:

- a) post material;
- b) method of installation;
- c) type of soil;
- d) state of soil consolidation;
- e) depth of frost line and propensity of soil to heave;
- f) size, shape, height, and weight of the pipeline marker assembly;
- g) exposure to external forces such as wind, high water, currents, large livestock, or wildlife;
- h) depth of pipeline to be marked.



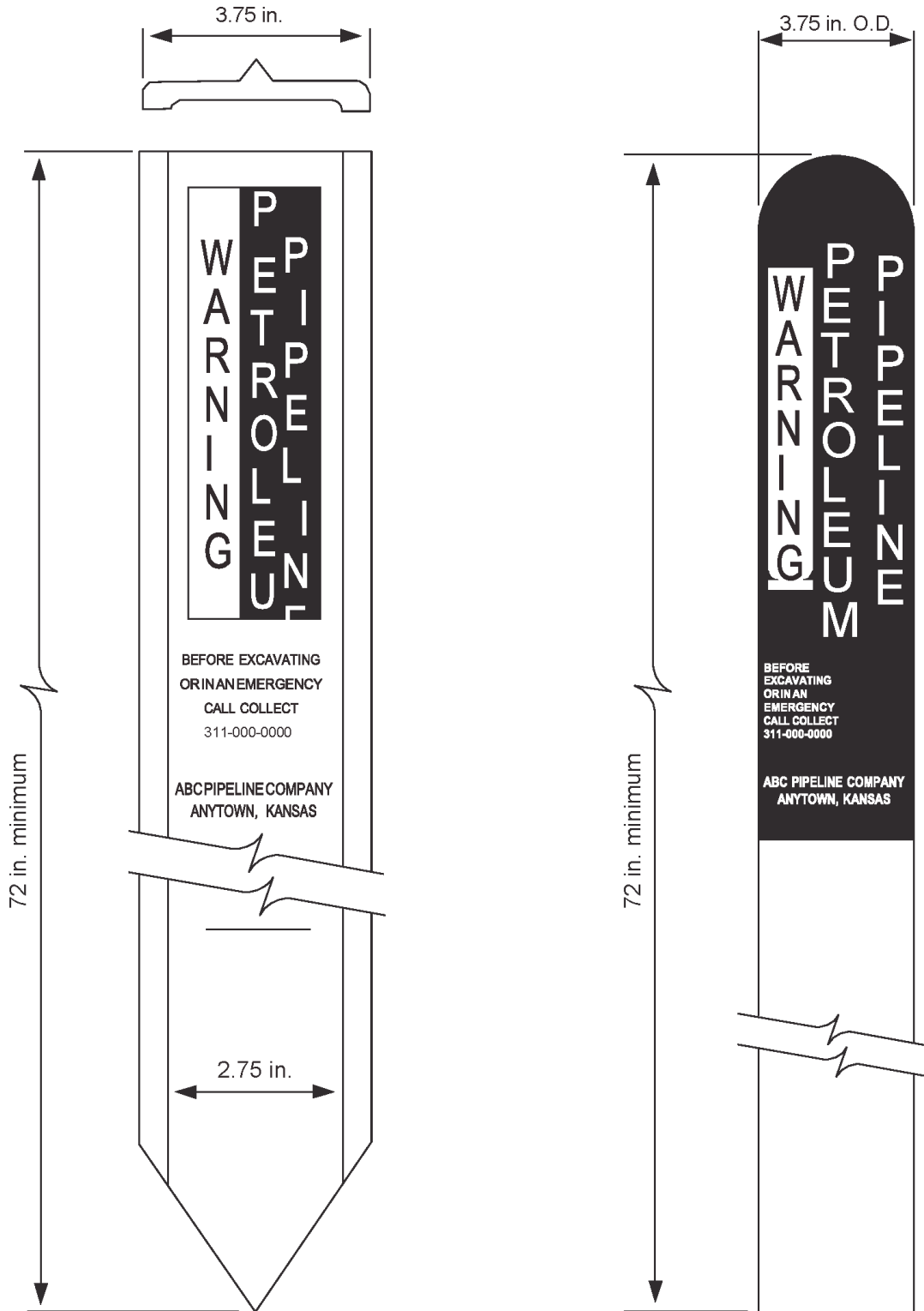

Figure 4—Line Markers

Consideration should also be given to attaching the message portion of any marker to pipeline vent pipes, fences, fence posts, or other existing posts to reduce the overall clutter at the site, provided that in the case of line markers, the requirements noted in 5.3.1 are met.

**5.5.3** Aboveground markers should be sufficiently elevated to allow them to be clearly viewed from a distance, and to allow them to remain visible above normal vegetation or snow accumulation. A minimum height of 4 ft above grade is recommended. The effect that agriculture use and/or type of crops raised has on the visibility of the marker should be considered when determining the location and height of the marker.

**5.5.4** When necessary, the post holes should be backfilled with concrete.

**5.5.5** When installing posts, caution should be exercised to avoid underground structures.

**5.5.6** The bottom of posts may be modified or fitted with transverse members to inhibit unauthorized removal or ejection by frost heaving.

## **6 Aboveground Pipeline Facility Marking and Signage Practice**

### **6.1 Pipelines**

49 *CFR* Part 195 requires that line markers be installed at locations where the pipeline is aboveground in areas that are accessible to the public.

### **6.2 Pipeline Facilities Signs**

Pipeline facilities such as stations, terminals, tank farms, valves, metering, or pipeline junction manifolds should be marked with appropriate signage. Figure 9 shows examples of signs. These signs should contain the name of the Pipeline Operator with a telephone number, including an area code, where the Pipeline Operator can be reached at all times and the name of the facility. Other information, such as the type or name of the facility, a physical address of the location, and how to contact 911 or providing emergency instructions may also be included on signage. Prohibitions and warnings are often included on signage.

### **6.3 Sign Placement**

Pipeline facility signs should be placed on all sides of the facility accessible to the public, at the facility entrance or entrances, and in sufficient numbers so that the facility is clearly identified.

## **7 Inspections and Maintenance**

The inspection, maintenance, and replacement of markers and signs should be a part of the Pipeline Operator's regular maintenance procedures. Markers and signs, along with their supporting structures, should be maintained in their original state of effectiveness. Damaged, defaced, or missing markers and signs should be replaced. Markers and signs should not be obscured by vegetation. Markers and signs whose effectiveness has been compromised by construction, damage, or fading should be relocated or replaced to restore effective marking. Pipeline Operators should periodically examine new locations for signage due to changing land use, flooding, re-routing, or other reasons that signage should be added or replaced.

Installation of pipeline markers in rural, farming and ranching areas may require additional precautions. Pipeline Operators should determine whether pipeline markers installed in rural, farming or ranching areas require additional anchoring or barriers to prevent inadvertent removal or damage from livestock.

Installation of pipeline markers in highly urbanized areas may pose challenges. Pipeline Operators should research if there are any city ordinances, permit requirements or deed restrictions on installation of pipeline markers.

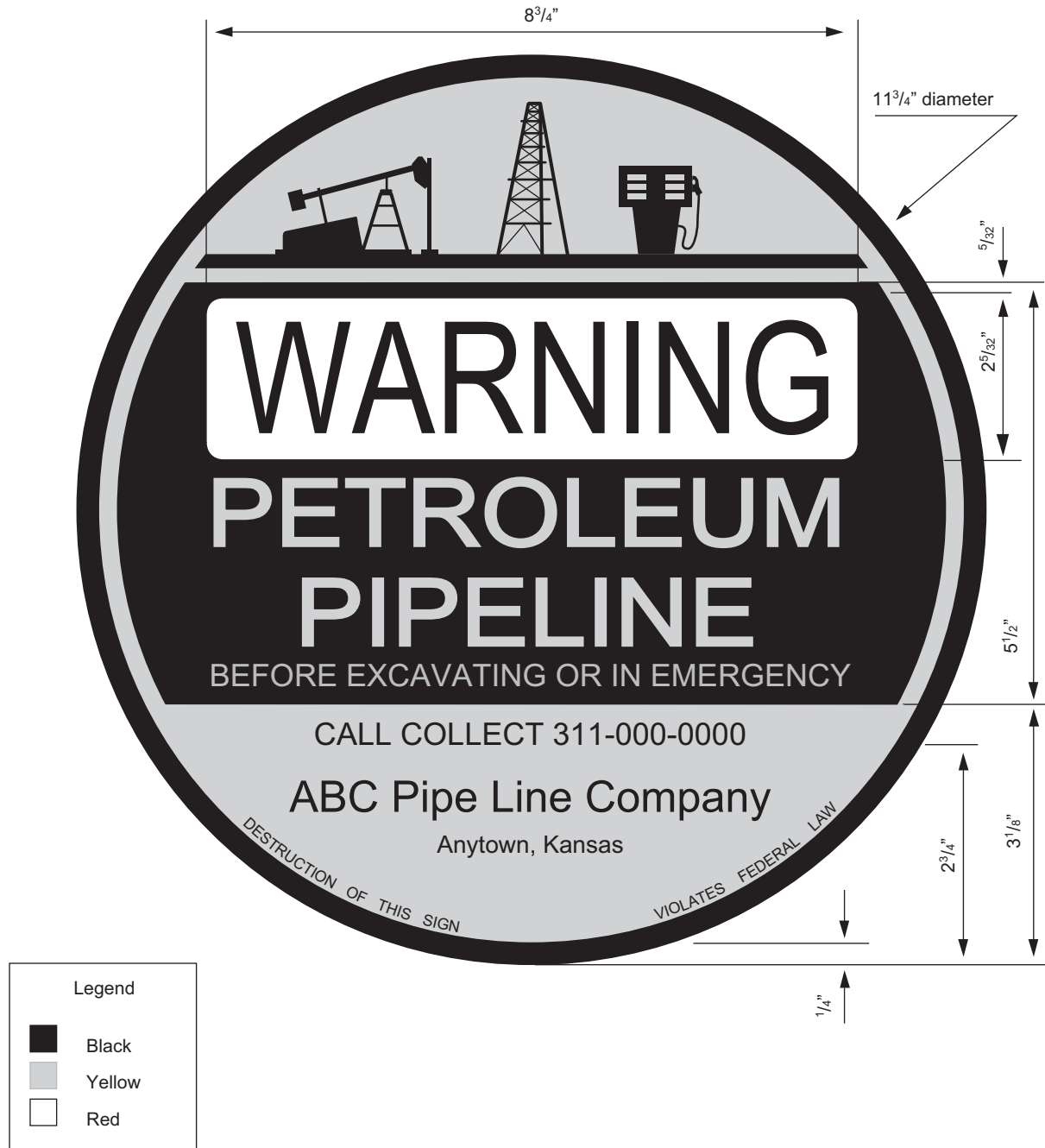

- NOTE 1 Recommended color samples of the red and yellow to be used on this sign are available on loan from the American Petroleum Institute's Manufacturing, Distribution, and Marketing Department.
- NOTE 2 Minor variations in letter style are acceptable provided that the minimum letter size and stroke width recommendations in 5.3.2 are accepted.
- NOTE 3 Sign to have 4 <sup>9</sup>/<sub>32</sub> in. holes on 11 in. b.c. at vertical and horizontal centerlines.

Figure 5—Line Marker

Discussions with state and local agencies as well as neighborhood community associations may be required. Consideration should be given to installing signage along the pipeline so that the route of the pipeline is clearly marked but addresses any ordinances, permit requirements or deed restrictions.

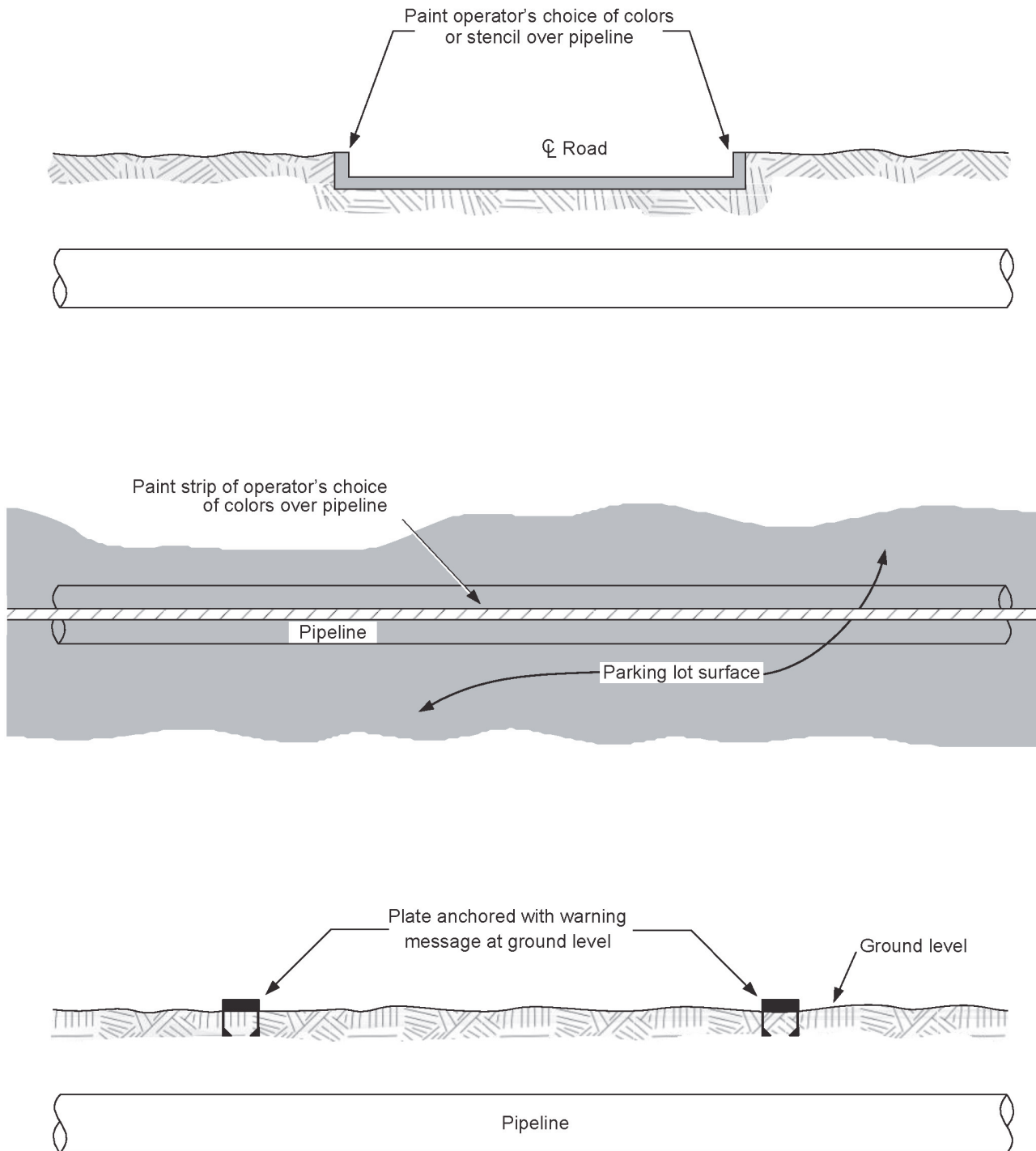
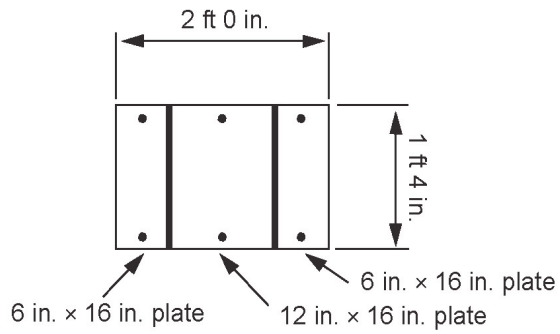

**Figure 6—Examples of Surface Markers**



NOTE Use sharply contrasting colors.

**Figure 7—Pipeline Sign for Navigable Waterways**



1 — Figure Marker

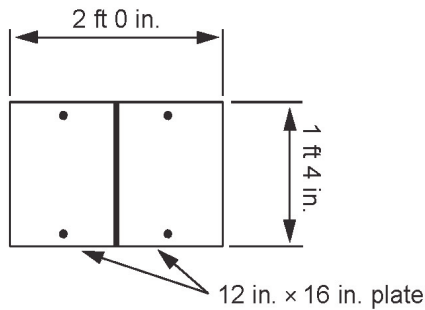

2 — Figure Marker

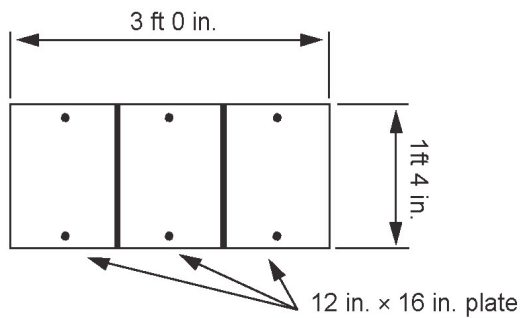

3 — Figure Marker

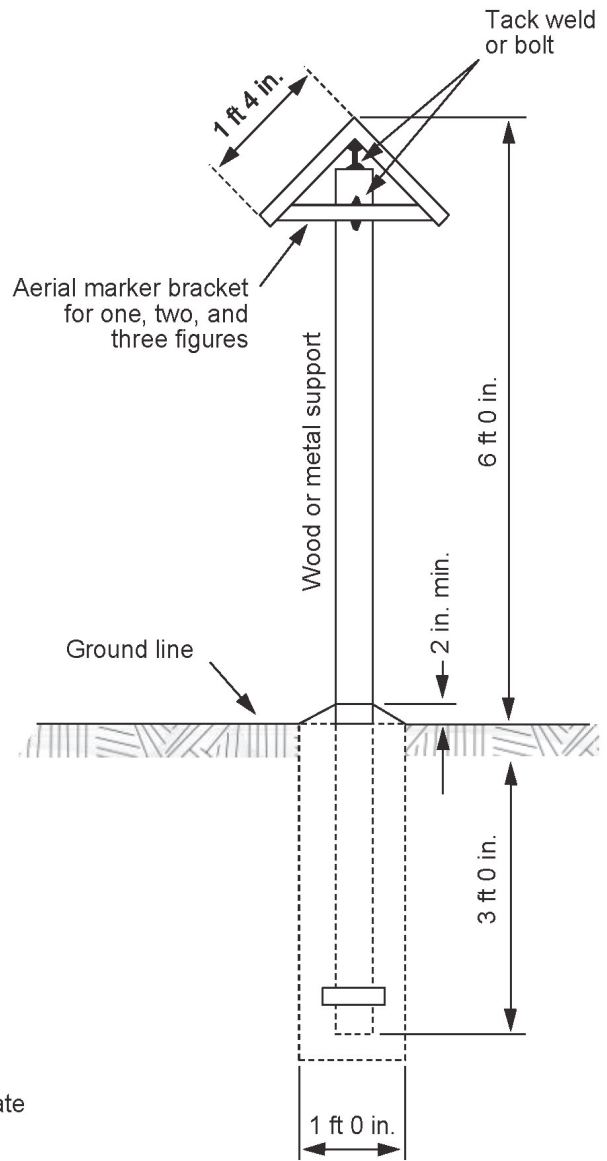

NOTE Use sharply contrasting colors

Figure 8—Typical Aerial Markers

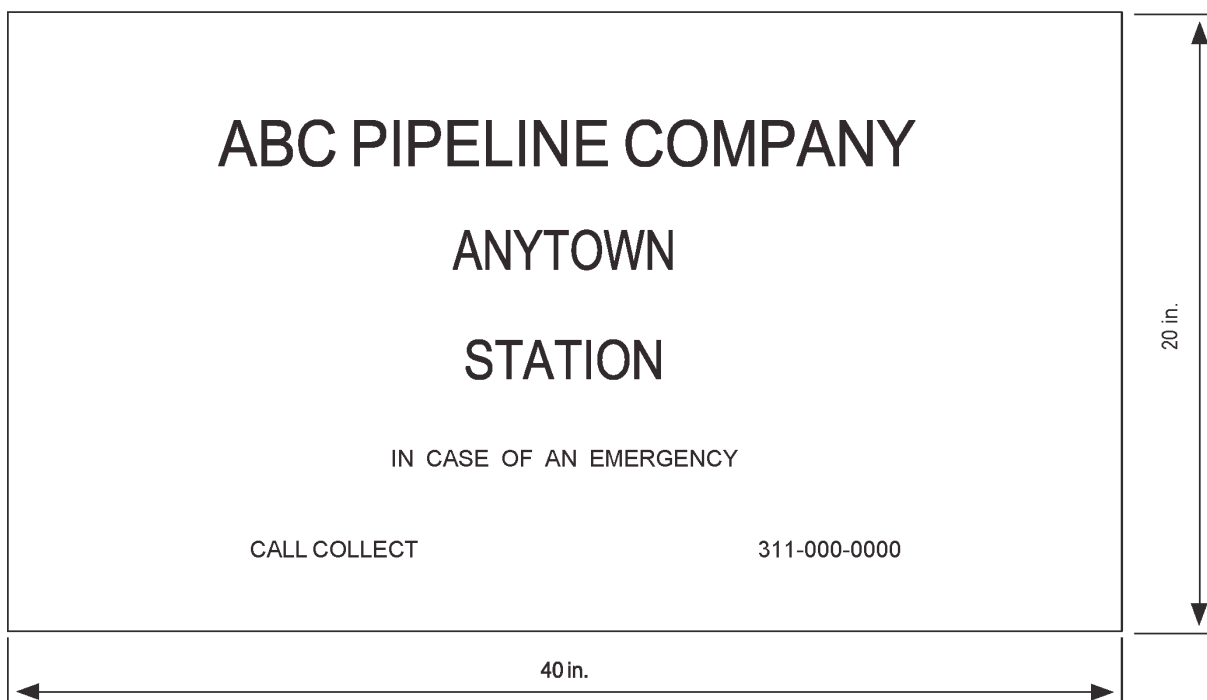
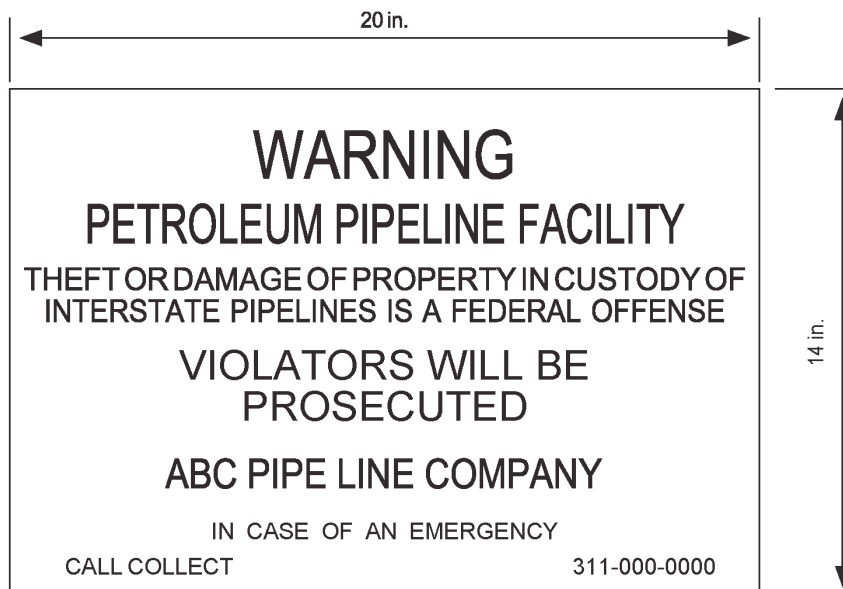

**Figure 9—Typical Pipeline Facility Signs**

© 2018 American Petroleum Institute. All rights reserved.

You may not edit, reproduce, or distribute this document by electronic or other means, including via e-mail.  
If you receive a copy of this document in violation of these terms of use, please report to API at [APIpubs@api.org](mailto:APIpubs@api.org).





AMERICAN PETROLEUM INSTITUTE

1220 L Street, NW  
Washington, DC 20005-4070  
USA

202-682-8000

**Additional copies are available online at [www.api.org/pubs](http://www.api.org/pubs)**

Phone Orders: 1-800-854-7179 (Toll-free in the U.S. and Canada)  
303-397-7956 (Local and International)  
Fax Orders: 303-397-2740

Information about API publications, programs and services is available  
on the web at [www.api.org](http://www.api.org).

**Product No. D11095**

© 2018 American Petroleum Institute. All rights reserved.

You may not edit, reproduce, or distribute this document by electronic or other means, including via e-mail.  
If you receive a copy of this document in violation of these terms of use, please report to API at [APIpubs@api.org](mailto:APIpubs@api.org).